

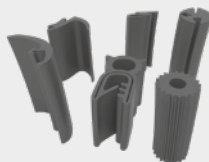

Rubber Screw Extruders – Barwell SX Range

Cold Feed Rubber Screw Extruders – ideal for the continuous extrusion of most basic rubber processing compounds



...a lifetime of reliability and support



BARWELL SX RANGE OF RUBBER SCREW EXTRUDERS

The Barwell SX range of cold-feed rubber screw extruders is designed for the precise and accurate process control of rubber and polymer compounds.

Our new high-efficiency screw extruders are built with innovative features, which focus on efficiency, more accurate process control, and high output levels. SX machines provide a more cost-effective method and a viable alternative to a Barwell Gear Pump when continuous performance is needed but without the complexities experienced when using various material types and hardnesses.

- Provides 24/7 rubber production
- A cost-effective alternative to a Gear Pump if the material is not complex to process
- A quick and automated method of rubber production
- Operator-friendly, requiring minimal user training, increasing production capability
- Robust, safe, reliable, and easy to maintain



FEATURES

- Features
- TCU Heating controls
- Schneider low voltage electrical appliance
- ABB Speed control frequency converter
- Screw driven belt driven motor and reducer
- Temperature control precision +/- 1°C
- Screw hardness rated to HRC65-68
- Barrel hardness rated to HRC65-70
- Screw material (38GrMoAcA)
- Nitride Steel (HV900)
- Siemens AC motor screw for speeds ranging from 1-70 rpm
- Feeding system uses powered rollers to the screw and includes a broken feed alarm
- Pressure sensor and pressure protection, including temperature sensor
- Speed control frequency converter for the main screw drive with temperature control precision
- All powered devices linked to Emergency Stops
- Variable Feed roller with a servo motor to ensure consistent feed for the screw

OPTIONS

- Barrier flight mixing screw or Transfer Screw
- Vacuum screw option – used to remove moisture and gases from extruded material
- Industry 4.0 – 9” Colour HMI with 5000 product database Including:
 - WiFi remote VNC and iPhone app control.
 - Data capture module to collect working data
- Allow remote access to plc and machine to email alarm messages
- OPC-UA connectivity for SPC data collection
- Screw servo motor for precise screw speed operation
- Oil-cooled TCUs for certain materials exceeding 80 shore hardness



SIZES AVAILABLE AND OUTPUTS

- 50mm – 20D – 80 kg /h
- 65mm – 20D – 128 kg/h
- 75mm – 12D – 135 kg/h
- 75mm – 16D – 135 kg/h
- 75mm – 20D – 135 kg/h
- 90mm – 12D – 320 kg/h
- 90mm – 16D – 320 kg/h
- 90mm – 20D – 320 kg/h
- 120mm – 12D – 800 kg/h
- 120mm – 16D – 800 kg/h
- 120mm – 20D – 800 kg/h
- 150mm – 8D – 1000 Kg/h
- 150mm – 16D – 1000 kg/h
- 150mm – 20D – 1000 kg/h

PROCESSING MATERIAL FLEXIBILITY

Barwell SX Rubber Screw Extruders are capable of processing many types of compounds, including:

- EPDM
- NBR
- CR
- CSM
- SBR
- FKM



BENEFITS

- Highly accurate and consistent production – consistent mixing of material and temperature control throughout the process (temperature control precision)
- 24/7 production capability
- Ease of operation and maintenance
- Minimal waste and low production costs
- Reduced downtime
- Processing flexibility
- Designed for safety



APPLICATIONS

Barwell SX Rubber Screw Extruders help companies to process products in several industries and sectors.

- | | |
|----------------------|------------------------|
| • Footwear | • Aerospace |
| • Sports and leisure | • IT and communication |
| • Automotive | • Military |
| • Pharmaceutical | • Ring and oil seal |
| • Construction | • General rubber goods |
| • Agricultural | |



TYPICAL PRODUCTS

Common extruded rubber products on a Barwell SX include:

- Rubber bushings
- Rubber cords
- Door seals
- Trims
- Tubes, pipes, and hoses
- Gaskets
- O-rings
- Solid round sections



SUPPORT

Barwell has always taken the approach that a customer needs to be supported for the lifetime of the machine.

- Commissioning, training and servicing packages available
- Genuine spare parts
- Technical support

barwell Support 
Advice | Spares | Service

ENHANCED SAFETY

Health and safety is a primary concern for those responsible for machine maintenance and operator safety.

Barwell machines are manufactured with safety in mind and are supplied with a number of features to ensure safe operation.

Barwell machines are compliant with CE regulations and equivalents.



Barwell Global Ltd.

Unit 1, 9 Burrel Road, St. Ives,
Cambridgeshire, PE27 3LE United Kingdom

✉ info@barwell.com
☎ +44 (0) 1480 832 860
🌐 www.barwell.com

Barwell Global USA

2868 Westway Drive, Unit E,
Brunswick, Ohio 44212-5661 USA

✉ info@barwellusa.com
☎ +1 330 225 9557
🌐 www.barwellusa.com

barwell 